

An aerial photograph of a suburban residential neighborhood. The houses are arranged in a grid-like pattern with streets and green spaces. In the lower right quadrant, there is a large school building with a distinctive white, multi-faceted roof. Adjacent to the school are several sports fields, including a blue track and a red and green field. The text 'STANDARDIZING SCHOOL ZONES' is overlaid in large, bold, white letters with a black drop shadow, centered in the upper half of the image.

# STANDARDIZING SCHOOL ZONES

# What is Safe Routes to School? (SRTS)

“An initiative that works to make it safe, convenient, and fun for children to walk and bicycle to and from schools” ([Safe Routes Partnership](#))

[MA SRTS](#) has worked with schools throughout the state for 20+ years on Education, Encouragement, Engagement, Evaluation, Equity and Engineering.

[Boston SRTS](#) led by Boston Public Health Commission began 2015 added it's first full-time staff person in Transportation in 2023.

Goals include:

- Making active transportation a lifelong habit
- Improving on-time arrival and readiness to learn
- Strengthening the relationship between the schools and the community
- Cultivating community partners who share the vision of creating safe, low-stress, traffic calmed streets around schools
- Reducing pediatric crashes (i.e. pedestrian and bike crashes in 4-17 y.o. residents)



# What is the city doing to improve safety and calm traffic near schools?

**Safety Surge Program** (speed humps, safer intersections, safer signals)

**School Zone Sign & Crosswalk Refresh (2023)**

**Standardize School Zones**  
(topic of discussion today)



# Safety Surge Program: Speed Hump Zones

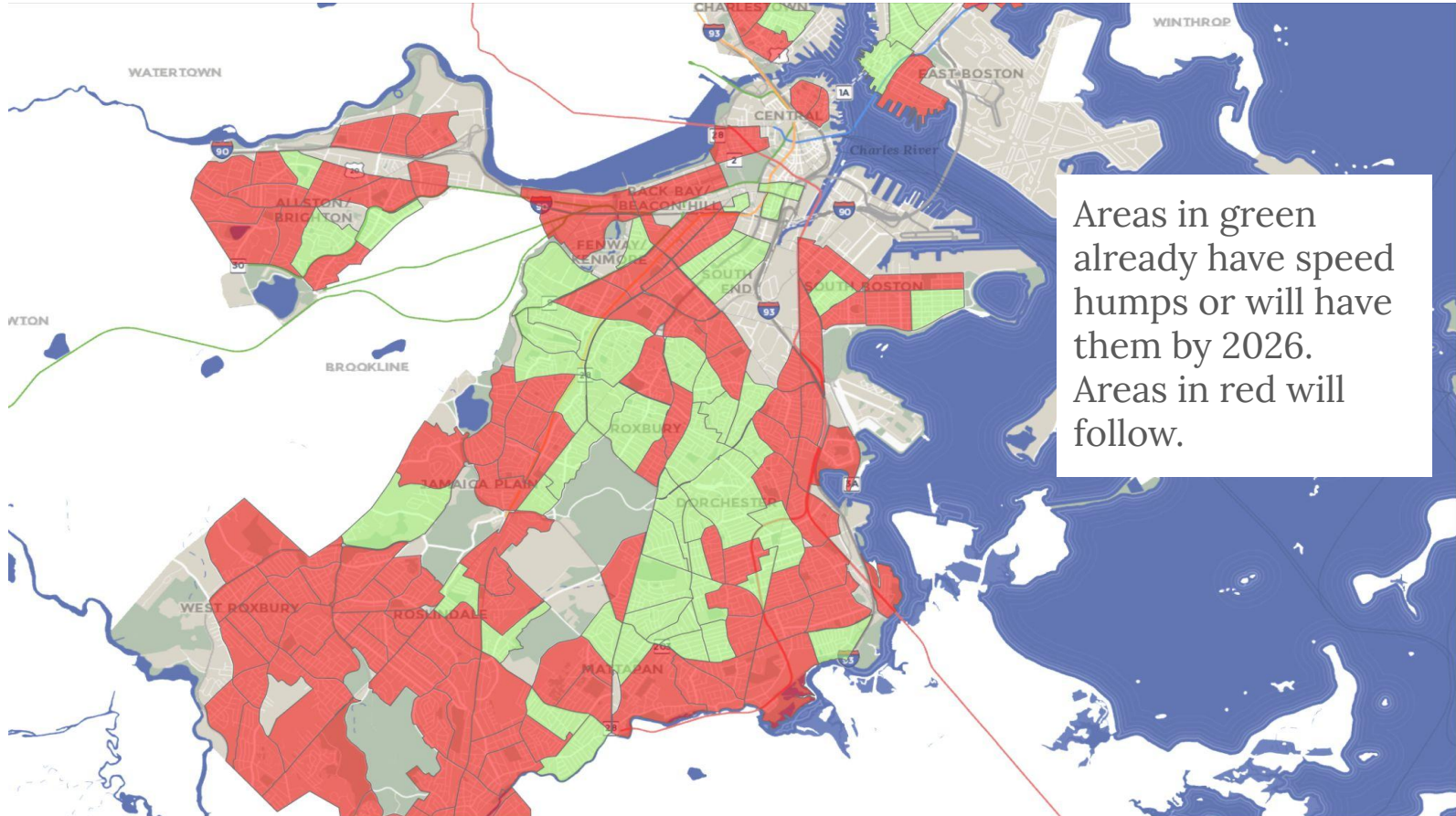

# Schools in Speed Hump Zones

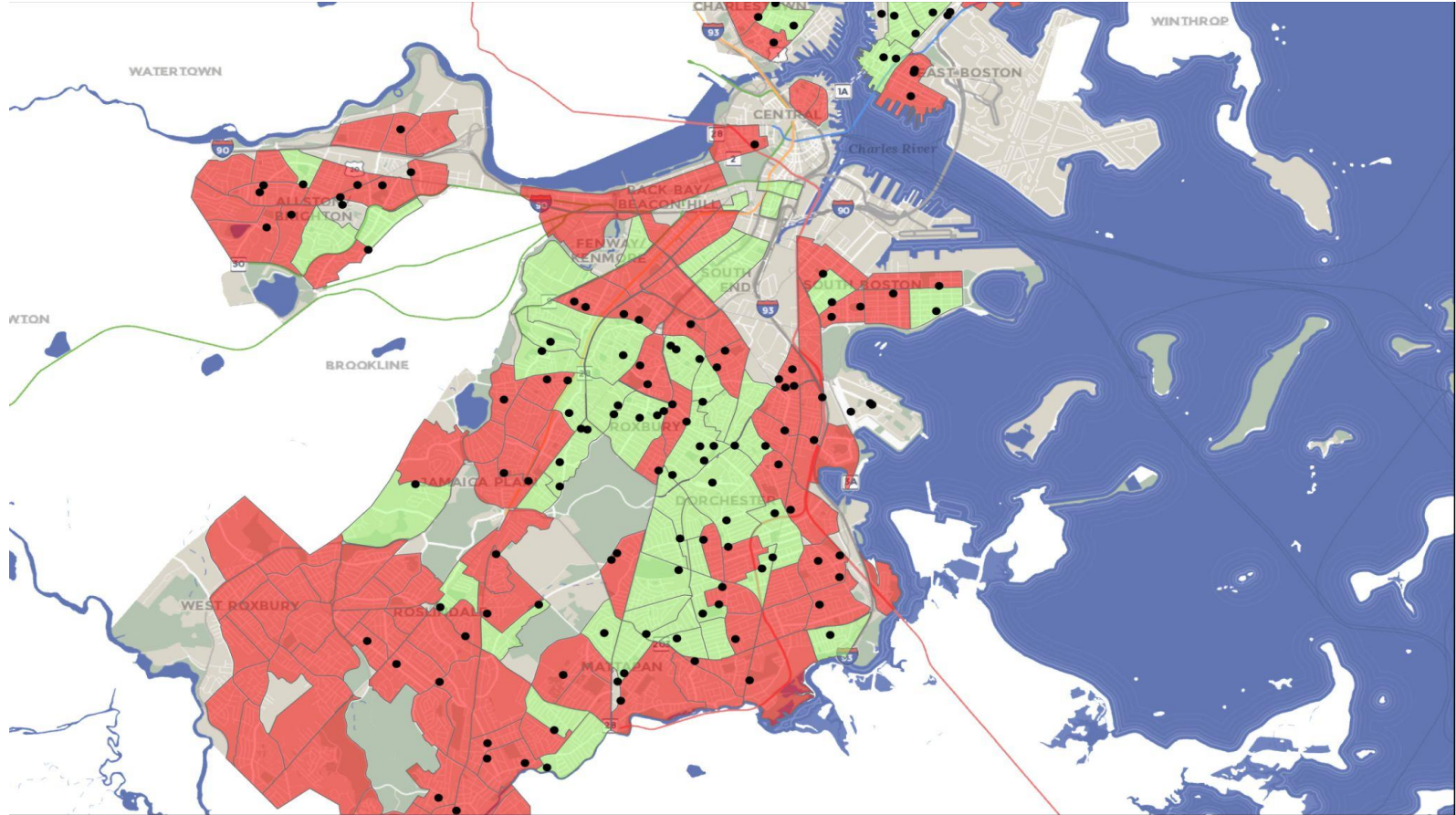

# School Zones - 2012 MassDOT Guidance

- 300' max from school building
- Focus on Elementary Schools
- Only allowed where the school or grounds abuts the street

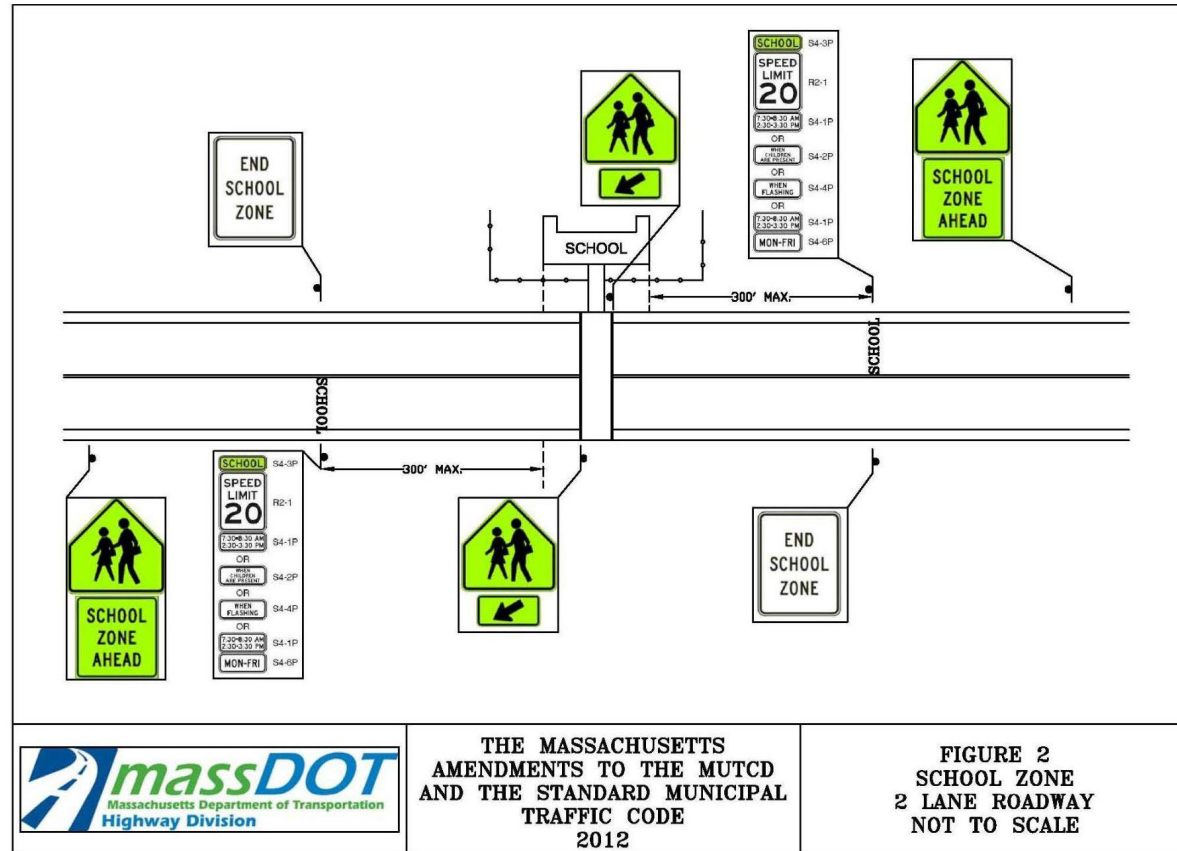

THE MASSACHUSETTS  
AMENDMENTS TO THE MUTCD  
AND THE STANDARD MUNICIPAL  
TRAFFIC CODE  
2012

FIGURE 2  
SCHOOL ZONE  
2 LANE ROADWAY  
NOT TO SCALE

## School Zones - 2022 MassDOT Guidance

- At least 200' in advance of school grounds, a school crossing, or other school related activities, up to ¼ mile
- Should be kept as short as possible while including the section of roadway in the vicinity of the school property that school children will be entering or crossing
- Includes Elementary and Secondary Schools (K-12)

## School Zones - 11th (2023) edition of Federal MUTCD

- At least 200 feet in advance of the school grounds or a school crossing;
- The maximum beginning point of a reduced school speed limit zone should not be greater than 500 feet in advance of the school grounds or a school crossing



# Proposal for City-wide School Zone Program

- Update city details for school zones
- Expand where we use them
- Implement throughout the city
- Define special use cases:
  - School Zones for Individual Schools
  - School Zones on Arterial Roads
  - School Zones for Clusters of Schools
  - School Zones for a Campus of Schools
  - Schools Zones within a 20 mph Safety Surge/Neighborhood Slow Streets Zone



CHARLES SUMNER LOWER

CHARLES SUMNER UPPER

CORINTH ST

WASHINGTON ST

CLIFFONDALE ST

KITREDGE ST

POPLAR ST

HAWTHORNE ST

MURRAY HILL RD

BASILE ST

LINDALL ST

FLORENCE ST

CUMMINS HWY

SHERMAN ST

SHERWOOD ST

PROSPECT AVE

SYCAMORE ST

JONSMOOD RD

BROOKDALE ST

RIDGE ST

BEXLEY RD



WALNUT AVE

HAROLD ST

MUNROE ST

MARTIN LUTHER KING JR. BLVD

CRESTWOOD PK

TOWNSEND ST

HAZELWOOD ST

BRIDGE CHARTER

HARRISHOF ST

TOWNSEND ST

ELLIS ELEMENTARY

HOLWORTHY ST

BOSTON LATIN ACADEMY

HOLLANDER ST

TROTTER ELEMENTARY

DECKARD ST

WARREN ST

WAUMBECK ST

WYOMING ST

CRAWFORD ST

HAROLD ST

WABENO ST

ABBOTSFORD ST

RUTHVEN ST

HUMBOLDT AVE

WABON ST

WALNUT AVE

# Upcoming MA SRTS Events

Tuesday, April 23: [SRTS School Spring Webinar: New Tools for Schools](#)

Wednesday, May 1: [Massachusetts Walk, Bike, and Roll to School Day](#)

Thursday, June 6: [Safe Routes to School Awards Ceremony at the State House](#)



**New Tools for Schools**  
2023 – 2024 School Year

**April 23, 2024**  
3:00 PM

**massDOT**  
Massachusetts Department of Transportation

**MASSACHUSETTS**  
Safe Routes to School  
MASS GOV SAFE ROUTES TO SCHOOL

The flyer features four photographs: a group of diverse people, a group holding a sign with a Pikachu mascot, a person on a bicycle, and a group of cyclists wearing blue helmets.